

ZMorph Interchangeable Toolheads

ZMorph VX is the most versatile and the most practical multitool 3D printer that you can put on a desk. With three different fabrication methods and dozens of available materials, ZMorph is designed to be your workhorse, versatile object making machine and a problem solver.

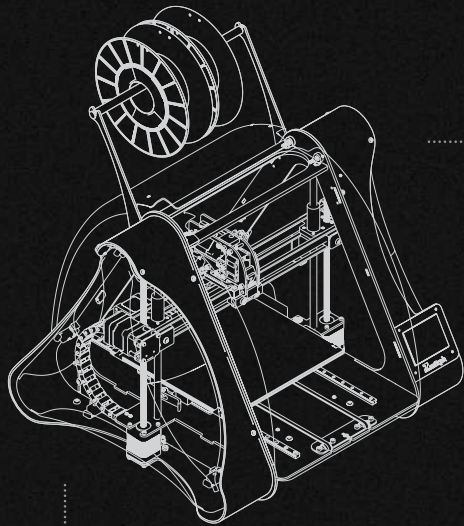

Interchangeable toolheads and worktables



3D printing worktable



CNC worktable

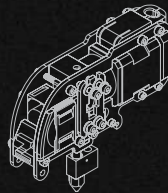

Plastic Extruder
3.00 mm

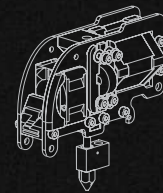

Plastic Extruder
1.75 mm

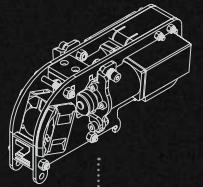

Dual Extruder



CNC PRO
Milling Toolhead

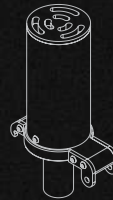

Laser PRO
Toolhead



Thick Paste
Extruder



Mixer Hotend



Specifications

1.75 mm Plastic Extruder

- Construction: High-quality 3 mm aluminum frame
- Hot End: ZMorph interchangeable nozzle 1.75 mm
- Temperature control: 1 thermistor
- Temperature range: 0 – 250C
- Nozzles: 0.2, 0.3, 0.4 mm
- Motor: Nema 17 stepper
- Extrusion: Direct Drive
- Work area: up to 250 x 235 x 165 mm
- Recommended printing resolution: 0.2 mm
- Supported printing resolution: 0.025 – 0.4 mm

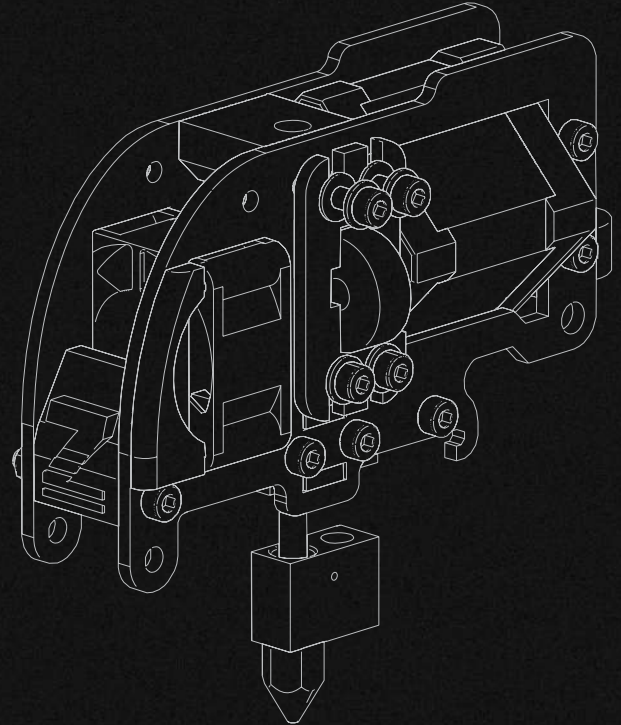

3.00 mm Plastic Extruder

- Construction: High-quality 3 mm aluminum frame
- Hot End: ZMorph interchangeable nozzle 3.00
- Temperature control: 1 thermistor
- Temperature range: 0 – 250C
- Nozzle: 0.3, 0.4 mm
- Motor: Nema 17 stepper with planetary gear
- Extrusion: Direct Drive
- Work area: 250 x 235 x 165 mm
- Recommended printing resolution: 0.2 mm
- Supported printing resolution : 0.025 – 0.4 mm
- Extruder dimensions: 150 x 115 x 55 mm

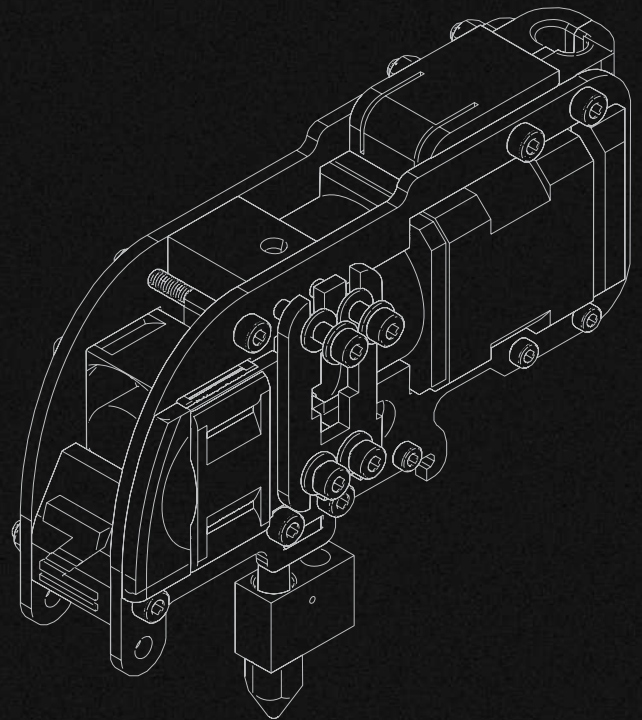



Specifications

DUAL PRO

- Construction: High-quality 3 mm aluminum frame
- Hot End: interchangeable Mixer Hotend
- Temperature control: 2 thermistors
- Temperature range: 0 – 250C
- Nozzle: 0.4 mm
- Motor: Nema 11 stepper with planetary gear x2
- Extrusion: Direct Drive
- Work area: up to 250 x 235 x 165 mm
- Recommended printing resolution: 0.2 mm
- Supported printing resolution: 0.025 – 0.4 mm
- Extruder dimensions: 170 x 115 x 70 mm

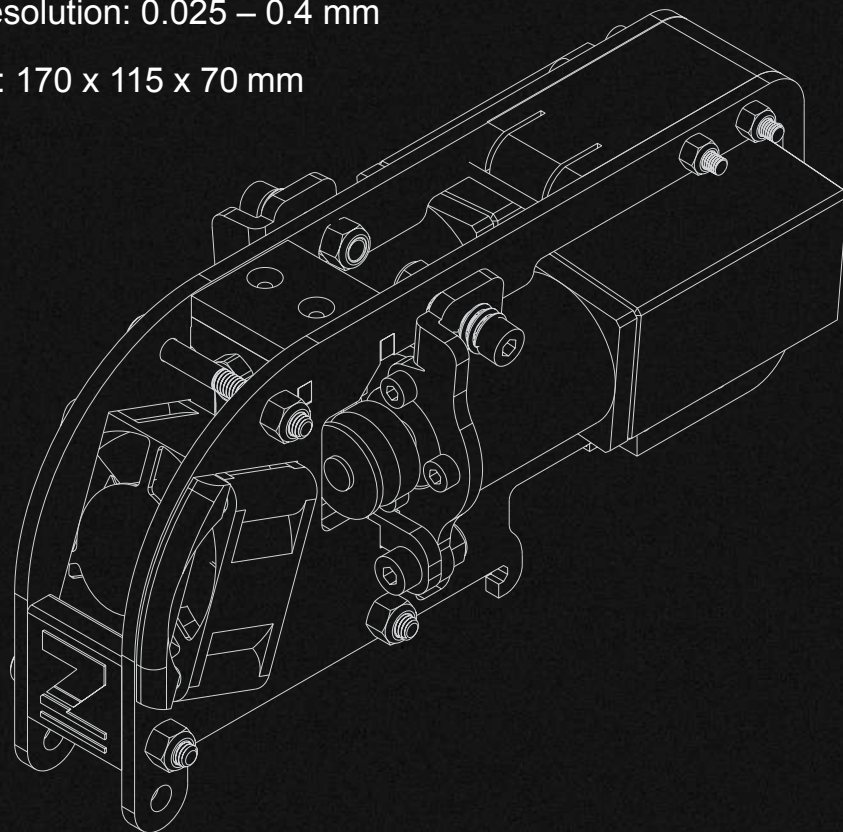



Specifications

CNC PRO

- Construction: Stainless steel housing
- Spindle motor: DC motor
- Hot End: ER-11 1/8" COLLET
- Power: 300 W
- Default work speed: 5 mm/s
- Max work speed: 120 mm/s
- Work area: up to 250 x 235 x 85 mm
- Recommended cutting depth: 0.5 mm for soft wood and polymers
- Max cutting depth: 15 mm for \varnothing 3 mm bit
- Dimensions: 90 x 55 x 175 mm

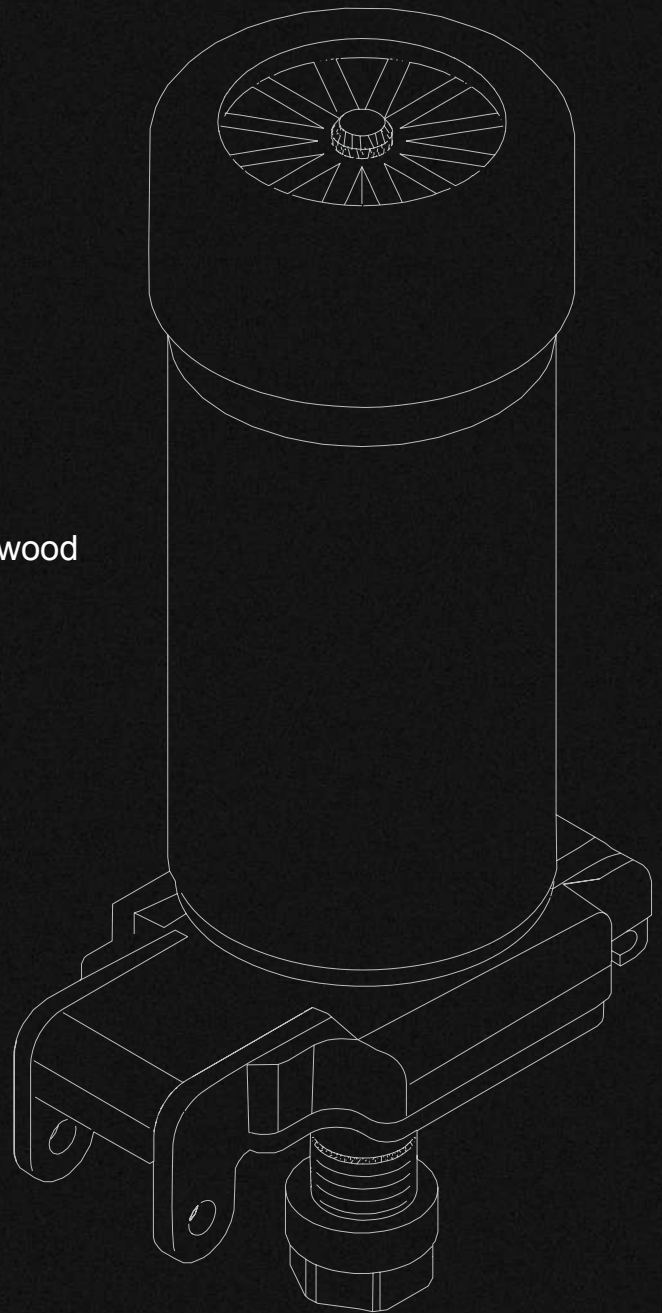



Specifications

Laser PRO

- Construction: High quality CNC-milled aluminum
- Laser type: 2.8W Blue Laser
- Default work speed: 15 mm/s
- Max work speed: 120 mm/s
- Work area: up to 250 x 235 x 85 mm
- Recommended cutting depth: 1 mm for cardboard
- Max cutting depth: 5 mm for cardboard
- Dimensions: 90 x 55 x 165 mm

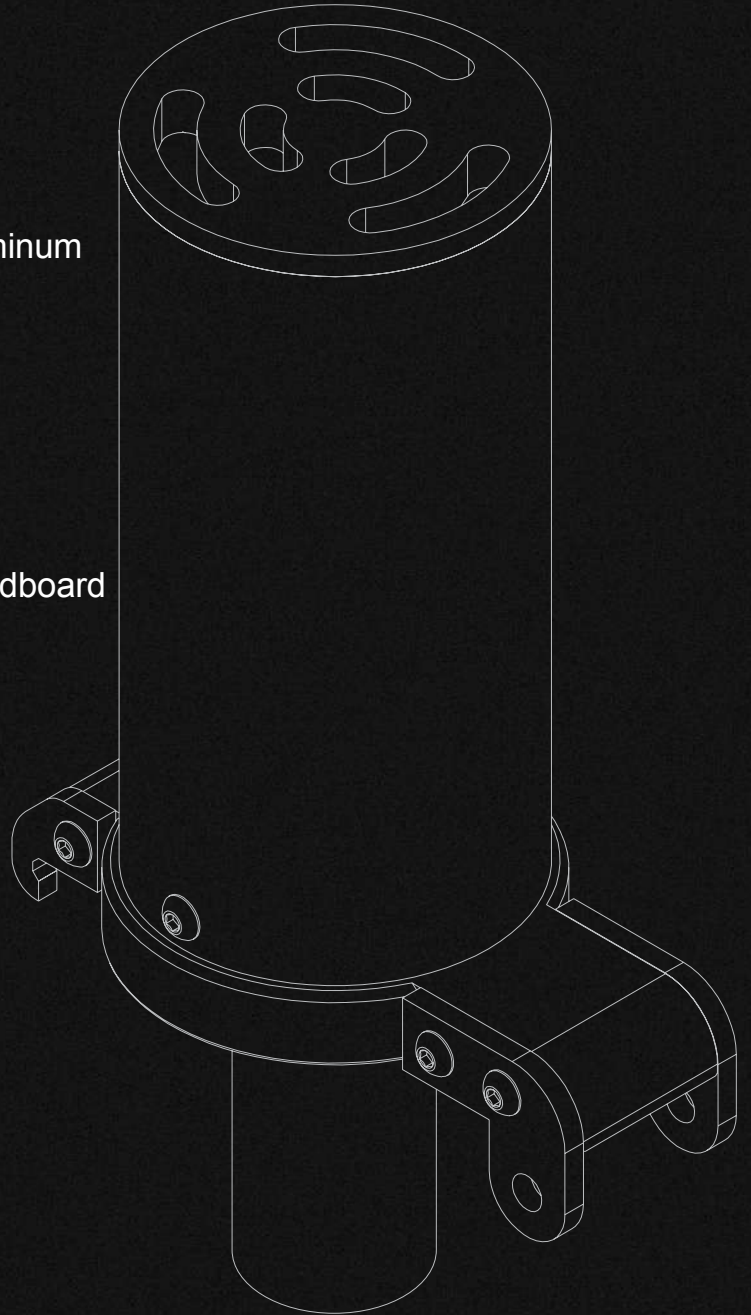



Thick Paste Extruder

Specifications

Thick Paste Extruder

- Construction: High-quality 3 mm aluminum frame
- Nozzle: 2 mm, 4 mm
- Motor: Nema 17 stepper
- Default work speed: 10 mm/s (depends on the material)
- Extrusion: Direct Drive
- Work area: up to 250 x 235 x 165 mm (without covers)
- Recommended printing resolution: 2 mm layer height (2000 microns)
- Supported printing resolution: 0.5 - 4 mm layer height (500 - 4000 microns)
- Material capacity: 100 ml
- Dimensions: 90 x 55 x 271 - 380 mm

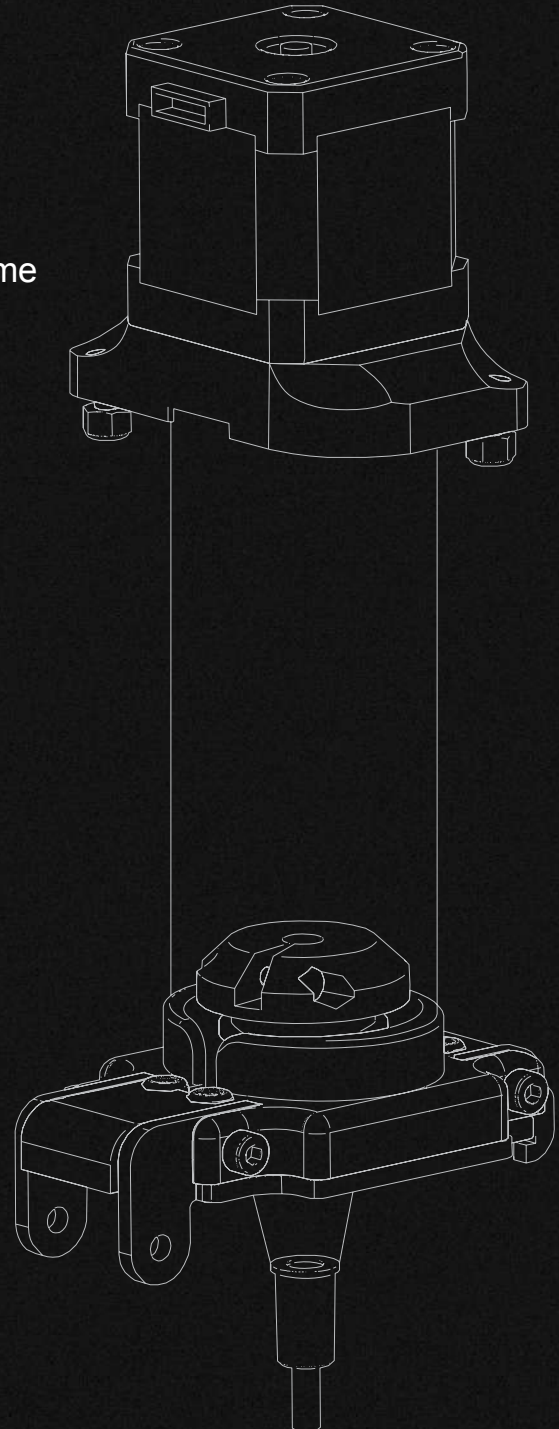



Zmōrph

www.novabeans.com

For more information
Visit: www.novabeans.com
Email: info@novabeans.com